

# AA-0274

## LED-Tester Module

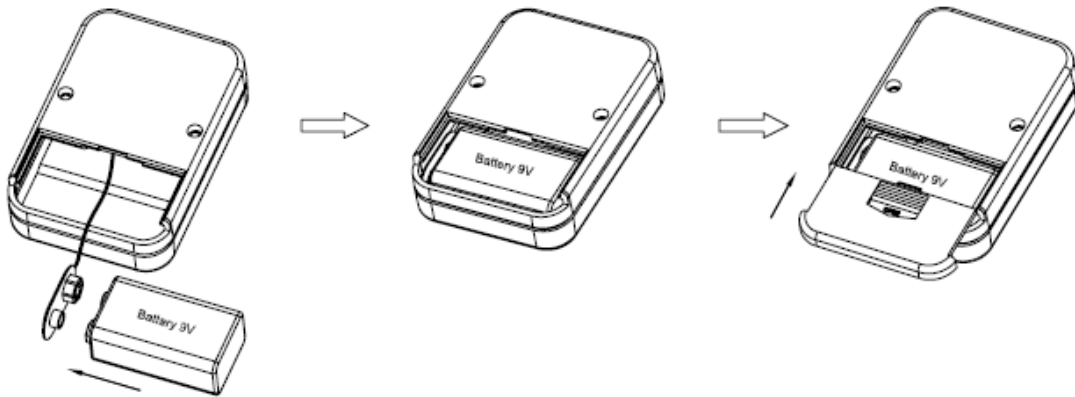

### Description:

The LED to be tested should be inserted according to the print on the front panel of the module, when inserted correctly the LED will light up. In the case that the LED doesn't light up, it is possible the LED has been inserted into the module incorrectly (please change polarity) or the LED is defective. The third possibility may be that the LED on test is an infrared LED which radiates light NOT visible to the human eye.

There are two 5 mA/10 mA-test contacts on this module, this makes it possible to test and select LEDs of the same brightness. For this test, you should insert one LED into the first 5 mA/10 mA contact and another equal LED into the second 5mA/10 mA socket, so it is possible to compare the brightness of the two LED's.

### Technical data:

**Operating voltage:** 9V battery (alkaline)

**LED connection:** socket strip

**LED-testing currents:** optional approx. 0.5, 1, 2.5,5,10,20,35,50 mA

**Dimensions:** approx.60x82x24mm

**Maintenance:**

The module is maintenance-free.

The module must not be exposed to extreme temperatures (more than 50°) and humidity.

Distributed by:  
TechBrands by  
Electus Distribution Pty Ltd  
320 Victoria Rd  
Rydalmere NSW 2116 Australia

Phone: 1300 738 555

Fax: 1300 738 500

[www.techbrands.com](http://www.techbrands.com)

Made in China